



130206

Bartscher GmbH
Franz-Kleine-Str. 28
D-33154 Salzkotten
Germany

Phone: +49 5258 971-0

Fax: +49 5258 971-120

Technical Support Hotline: +49 5258 971-197

www.bartscher.com



Version: 7.0

Date of preparation: 2025-04-10

Original instruction manual

1	Safety	2
1.1	Explanation of Signal Words.....	2
1.2	Safety instructions.....	3
1.3	Intended Use	6
1.4	Unintended Use	6
2	General information	7
2.1	Liability and Warranty	7
2.2	Copyright Protection	7
2.3	Declaration of Conformity	7
3	Transport, Packaging and Storage	8
3.1	Delivery Check.....	8
3.2	Packaging	8
3.3	Storage	8
4	Technical Data.....	9
4.1	Technical Specifications	9
4.2	List of Components of the Appliance	10
4.3	Functions of the Appliance.....	10
5	Installation and operation	11
5.1	Installation.....	11
5.2	Operation	12
6	Cleaning	17
6.1	Safety Instructions for Cleaning	17
6.2	Cleaning.....	17
7	Disposal.....	18



Read these instruction manual before using the appliance and keep it available at all times!

This instruction manual contains information about installation, operation and maintenance of the appliance and constitutes an important source of information and reference guide. The knowledge of all operational and safety instructions included in this manual is a prerequisite for safe and proper handling of the appliance.

Read this instruction manual before you use the appliance and particularly before you start the appliance to prevent injury or damage. Incorrect use may cause damage.

All important information contained in the operating instructions must be available to the appropriate staff at all time. The operator shall be responsible for their availability.

In addition to the operating instructions, you must comply with the general, legal and other applicable regulations for occupational safety and environmental protection.

EN

1 Safety

This appliance has been manufactured in accordance with technical standards currently in force. However, the appliance may be a source of hazards if used improperly or contrary to its intended purpose. All persons using the appliance must consider information included in this instruction manual and observe safety instructions.

1.1 Explanation of Signal Words

Important safety instructions and warning information are indicated in this instruction manual with appropriate signal words. You must strictly follow the instructions, to prevent accidents, personal injuries and property damages.



DANGER!

The signal word **DANGER** warns against hazards that lead to severe injuries or death if the hazards are not avoided.



WARNING!

The signal word **WARNING** warns against hazards that may lead to moderate or severe injuries or death if the hazards are not avoided.



CAUTION!

The signal word **CAUTION** warns against hazards that may lead to light or moderate injuries if the hazards are not avoided.

IMPORTANT!

The signal word **IMPORTANT** indicates possible property damages, which may occur if safety instructions are not observed.

NOTE!

The symbol **NOTE** indicates subsequent information and guidelines for the user on usage of the appliance.

1.2 Safety instructions

Electrical Current

- Too high a mains voltage or incorrect installation may cause electric shock.
- The appliance may be connected only if data on the rating plate correspond with the mains voltage.
- To avoid short-circuit, the appliance should be kept dry.
- If there are malfunctions during operation, disconnect the appliance from the power supply.
- Do not touch the appliance's plug with wet hands.
- Never take hold of the appliance if it has fallen into water. Immediately disconnect the appliance from the power supply.
- Any repairs or housing opening may be carried out by professionals and relevant workshops only.
- Do not transport the appliance, holding it by the power cord.
- Do not allow the power cord to come into contact with heat sources or sharp edges.
- Do not bend, pinch nor knot the power cord.

- Always completely unwind the power cord.
- Never place the appliance or other objects on the power cord.
- Always take hold of the plug to disconnect the appliance from the power supply.
- Check the power cord regularly for damage. Do not use the appliance if the power cord is damaged. If this cable is damaged, it must be replaced by customer service or a qualified electrician in order to avoid dangers.

Operator's responsibility

The operator is responsible for complying with the currently applicable laws, regulations, ordinances and existing national regulations on accident prevention, environmental protection, as well as the internal operation, operating and safety instructions that apply at the respective installation site.

Obligations of the operator:

- Operate the appliance and its components only in a technical condition that does not raise any objections, with functional protective and safety elements.
- Prepare risk assessment at work positions.
- Provide instruction and regular staff training. Pay special attention to and observe the section concerning safety and any safety hints.
- Provide suitable personal protective equipment (PPE)
- Observe the intervals of maintenance and cleaning.
- Document training/instructions, replacement of components.

Safety

Supervised Usage only

- Only supervised appliance may be used.
- Always remain in an immediate vicinity of the appliance.

Operating Personnel

- The appliance may only be operated by qualified personnel and trained specialist personnel.
- This appliance may not be operated by persons (including children) with limited physical, sensory or mental capabilities, nor by persons with limited experience and/or limited knowledge.
- Children should be supervised to ensure that they are not playing with or switching on the appliance.

Improper Use

- Unintended or prohibited use may cause damage to the appliance.
- The appliance may only be used when its technical condition is flawless and allows for safe operation.
- The appliance may only be used when all connections are executed according to rules of law in force.
- The appliance may only be used when it is clean.
- Use only original spare parts. Never attempt to repair the appliance on your own.
- Do not introduce any changes in the appliance nor modify it.

1.3 Intended Use

This appliance is only intended for use described in the operating instructions, with the supplied and approved components.

Any other use is considered against the intended purpose. The manufacturer shall not be liable for any damage due to unintended use. In such cases the responsible party shall only be the user/operator.

The following is an intended purpose:

- Mixing, pureeing, chopping, beating and stirring of suitable food products.

1.4 Unintended Use

An unintended use may lead to personal injuries or property damages caused by hazardous voltage, fire or high temperature. The appliance may only be used to perform tasks described in this instruction manual.

The following is an unintended use:

- Chopping of frozen food products.
- Chopping of very hard food products, e.g. ice cubes, nutmeg, coffee grains or cereals.

2 General information

2.1 Liability and Warranty

The appliance was built in accordance with the current state of the art and recognized technical safety principles. Nevertheless, during its use, there may be a threat to the health and life of the user or bystanders, or the danger of damage to the device or other assets. Warranty and liability claims for personal injury/property damage as well as defects at work are excluded if they can be attributed to one or more of the following causes:

- Use against the intended purpose
- Failure to follow/disregard the instructions and all related information
- Unauthorized structural or technical changes to the device
- Engaging insufficiently trained and insufficiently qualified personnel
- Operation with defective or incorrectly installed safety and protective devices
- Inadequate maintenance or cleaning
- Faults not fixed
- Use of prohibited media, cleaning agents, etc.
- Use of unauthorised spare parts
- Errors in operation or other misuse
- Disasters caused by foreign objects or force majeure
- Destruction of the type plate and stickers relevant for operation and safety

EN

2.2 Copyright Protection

This instruction manual, and texts, drawings and images included in it, as well as its other components are copyright protected. It is prohibited to reproduce this instruction manual (including its excerpts), in any form and by any means, and to use and/or transfer its content to third parties without manufacturer's written permission. Violation of the above results in obligation to pay compensation. We reserve the right to claim further damages.

2.3 Declaration of Conformity

The appliance meets the currently applicable standards and guidelines of the European Union. We confirm the above in the EC Declaration of Conformity. We may provide relevant Declaration of Conformity upon request.

3 Transport, Packaging and Storage

3.1 Delivery Check

Immediately upon reception, check the delivery for completeness and possible shipping damage. In the case of visible transport damage refuse to accept the appliance or accept it conditionally. Mark and note the scope of damage in shipping documents/consignment list of the shipping company and lodge a complaint.

Concealed damage must be reported immediately upon its discovery, as compensation claims may only be filed within applicable time limits.

If you find that parts or accessories missing, please contact our Customer Service Department.

3.2 Packaging

Do not dispose of the appliance cardboard box. It may be used to store the appliance when relocating or when shipping the appliance to our service point in the case of any damages.

The packaging and its elements are made of recyclable materials. Particularly, these are: plastic films and bags, cardboard box.

EN

When disposing of the packaging, observe applicable domestic regulations. Recyclable packaging materials should be recycled.

3.3 Storage

Leave the packaging closed until installation of the appliance; observe external indications concerning method of placing and storage. Store the packaging in the following conditions only:

- in closed rooms;
- in dry and dust-free surrounding;
- away from aggressive agents;
- in a location protected against sunlight;
- in a location protected against mechanical shocks.

In the case of extended storage (over three months), make sure you check the condition of the packaging and the parts regularly. If needed, replace the packaging with a new one.

4 Technical Data

4.1 Technical Specifications

Name:	Stick mixer set, 5 levels speed control, 0,7kW
Item No.:	130206
Material:	stainless steel
Mixing bar length, in mm:	207
Speed levels:	5
Maximum rotational speed of mixer, in RPMs:	17000
Maximum rotational speed of whisk, in RPMs:	17000
Power supply:	0,7 kW 230 V 50-60 Hz
Dimensions (W x D x H) in mm:	330 x 245 x 260
Weight in kg:	2,1

EN

We reserve the right to implement technical modifications!

Version / Characteristics

- Detachable mixing stick
- Easy switching between various functions
- ON/OFF button
- Ergonomic design
- The set includes: 1 wall mount

4.2 List of Components of the Appliance

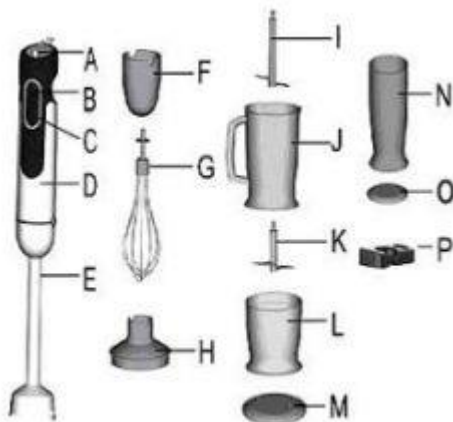

Fig. 1

EN

A Speed control

B Switch I

C Switch II

D Motor block

E Mixing stick

F Whisk holder

G Whisk

H Lid for special containers,
500 ml + 1.250 ml

I Sickle blade for special container,
1.250 ml

J Special container, 1.250 ml

K Sickle blade for special container, 500 ml

L Special container, 500 ml

M Anti-slip pad for special containers,
500 ml+1.250 ml

N Mixing container, 800 ml

O Anti-slip pad for mixing container, 800 ml

P Wall mount

4.3 Functions of the Appliance

The stick mixer set features numerous applications thanks to easy switching over of accessories for various functions (mixing, pureeing, chopping, beating and stirring of food products).

5 Installation and operation

5.1 Installation

Unpacking / Positioning

- Unpack the appliance, remove all external and internal packaging elements and shipment safeguards.



CAUTION!

Choking hazard!

Prevent children from accessing packaging materials, for instance: plastic bags and EPS elements.

- If the appliance is covered with a protective film, remove it. Remove the film slowly, so no glue residues are left. Remove any glue residues with the use of a suitable solvent.
- Be careful not to damage the rating plate and warning labels affixed to the appliance.
- **Never** place the appliance in humid or wet environment.
- Place the appliance in a way making the connections easily accessible, so that they may be quickly disconnected if such a need arises.
- When selecting the installation site, please consider the following items:
 - The mounting surface must be even, sufficiently load-bearing, waterproof, dry and resistant to high temperatures.
 - Make sure that the designated escape routes are clear.
 - Ensure a stable position.
 - Allow sufficient space for work, maintenance and cleaning.
 - Leave the supply and exhaust air vents, if any, free.
 - Comply with applicable technical and building regulations.

Wall-Mounting



Fig. 2

The set includes practical wall-mount with fixing elements, which provides for storage of stick mixer in a manner facilitating easy access saving of space at the same time.

1. Install the wall-mount in an easily accessible place, using the enclosed fixing elements and then insert the mixing stick in the wall-mount.
2. If you do not use the wall-mount, place the mixing stick on a flat surface.

NOTE: If left standing upright, the fixing stick features low stability.

Power supply connection

EN

- Verify if technical data of the appliance (see rating plate) correspond with the local electric power grid specification.
- Connect the appliance to a single, properly grounded mains socket with protective contact. Do not connect the appliance to a multi-socket.
- The power cord should be laid in a way preventing anyone from threading on it or tripping against it.
- Do not use the appliance with an external timer or remote control.

5.2 Operation



WARNING!

Danger of injury inflicted by sharp sickle blades of the appliance!

Exercise extreme caution when handling the stick mixer.

Hold the sickle blades by plastic upper part only, and use gloves resistant to cutting.

Installation and operation

Before the First Use

1. Make sure that all components of the appliance and accessories are available and in sound condition.
2. Prior to first use, thoroughly clean the appliance and equipment according to instructions in section 6 “Cleaning”.
3. Prior to assembly, thoroughly dry all components.
4. Prepare food products for processing.
5. Connect the appliance to a single grounded socket.

Using the Appliance as a Mixer

The stick mixer may be used especially for preparation of dips, sauces, soups, mayonnaise, nutrients for infants, as well as for mixing foods and milk shakes.

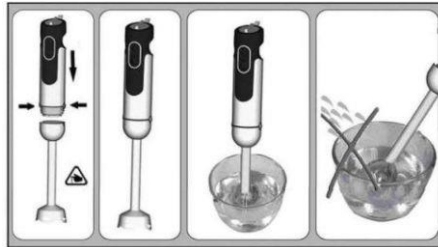

Fig. 3

1. Mount the stainless still mixing stick on the motor block until you hear a click.
2. Put and keep the mixing stick in a container with a product for mixing.

NOTE: The stick mixer may also be used in a container with a scale or in another container.



Fig. 4

3. Then select suitable speed level in the range of 1–5; to this end use the speed control located in the top part of the motor block.
4. In order to start the stick mixer, press switch I (for lower revolutions) or switch II (for higher revolutions).

ATTENTION!

Never operate the appliance outside a container.

5. After use, switch the appliance off and disconnect it from power supply (pull the plug out).
6. After use, screw the mixing stick out of the motor block.

ATTENTION!

Never use the stick mixer for more than 1 minute of uninterrupted work.

Using the Appliance as a Chopper

The stick mixer is equipped with accessories perfect for chopping meat, cheese, onion, herbs, garlic, carrot, walnuts, almonds, plums, etc.

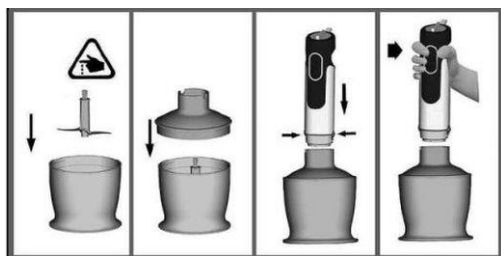

Fig. 5

EN

ATTENTION!

Never attempt to chop very hard food products, e.g. ice cubes, nutmeg, coffee grains or cereals.

Prior to Chopping

1. Carefully remove plastic cover of the sickle blade.
2. Mount the suitable sickle blade onto a central pin of the suitable special container.
5. Press down the sickle knife, until it locks in the special container.
6. Always place the special container on the anti-slip pad.
7. Put food products in the special container.
8. Place the lid on the special container.
9. Screw the motor block onto the lid of the special container, until it locks.
10. To operate the appliance as a chopper, use the switch II.
11. When operating, hold the motor block with one hand and the special container with the other one.
12. After use, switch the appliance off and disconnect it from mains socket (pull the plug out).

Installation and operation

13. Then screw the motor block off of the lid of the special container.
14. To finish with, remove the lid of the special container and then, carefully, the sickle knife.
15. Remove the ready food out of the special container.

Table for Processing of Products in Special Containers

Food type	Filling amount (max.)	Processing time (s)	Filling amount (max.)	Processing time (s)	Preparation
	Special container, 500 ml		Special container, 1.250 ml		
Meat	250 g	8	500 g	10	1 x 2 cm
Herbs	50 g	8	100 g	8	
Nuts	100 g	8	300 g	10	
Cheese	100 g	5	200 g	8	1 x 2 cm
Bread	80 g	5	160 g	6	2 cm
Onion	150 g	8	300 g	8	2 cm
Cakes	150 g	6	300 g	6	2 cm
Soft fruit	200 g	6	400 g	8	1 x 2 cm
Flour	/	/	400 g	10	/
Water	/	/	240 g		/
Yeast	/	/	8 g		/
Sugar	/	/	8 g		/
Salt	/	/	8 g		/

Using the Appliance with Whisk

The whisk should be used for beating cream and egg whites, mixing dough and instant desserts.

1. Insert the whisk into the holder and then screw the holder onto the motor block until it locks in place.
2. Put the whisk in a suitable container for mixing and select suitable speed level (1–5).
3. To operate the whisk, start the switch **I** or **II**.

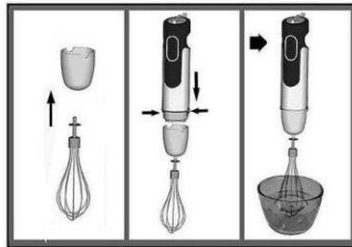

Fig. 6

EN

ATTENTION!

Never use the whisk for more than 2 minutes of uninterrupted work.

4. After use, switch the appliance off and disconnect it from mains socket (pull the plug out).
5. After use, screw the holder out of the motor block.
6. To end with, pull the whisk out of the holder.

6 Cleaning

The operator must ensure that the device and its safety components are kept in good condition. Control and safety systems should be checked for their effectiveness.

Maintenance, cleaning and repairs must only be carried out by suitably trained and specialised personnel.

If the safety devices need to be removed for maintenance, cleaning and repair, they should be reinstalled immediately after completion and their function should be checked.

All maintenance and cleaning work must be carried out in accordance with the operating instructions at the specified intervals.

6.1 Safety Instructions for Cleaning

- Before cleaning, disconnect the appliance from the power supply.
- Leave the appliance to cool down completely.
- Make sure water does not enter the appliance. Do not immerse the appliance in water or other liquids during cleaning. Do not clean the appliance with a pressurized water jet.
- Do not use any sharp or pointed, nor metal implements (knife, fork, etc.). Sharp or pointed implements may damage the appliance, and when in contact with live parts, they may cause electric shock.
- For cleaning, do not use any scouring agents that contain solvents nor corrosive cleaning agents. They may damage the surface.

EN

6.2 Cleaning



WARNING!

The sickle blades of the appliance are very sharp! Injury hazard!

Keep caution during operation of sickle blades!

Always use gloves resistant to cutting during cleaning of the sickle blade.

1. Clean the appliance regularly after the end of each working day, or more frequently if needed.
2. Clean the motor block and power cable with soft, damp cloth only.

ATTENTION!

Never immerse the motor block in water or other liquids.

3. Clean all detachable parts of the appliance with warm water and mild cleaning agent.
4. Rinse the cleaned elements in pure water.
5. At the end, leave these elements to dry in open air.

NOTE: All detachable parts of the appliance (except for the motor block) may be washed in a dishwasher.

6. Do not use excessive amount of washing nor descaling agent in a dishwasher.
7. If foods with intense colours are prepared with the use of the appliance, the plastic components may fade out and stain. Prior to placing these elements in a dishwasher, wipe them with vegetable oil.

7 Disposal

Electrical Appliance

EN



Electric appliances are marked with this symbol. Electrical appliances must be disposed of and recycled in a correct and environmentally friendly manner. You must not dispose of electric appliances with household waste. Disconnect the appliance from the power supply and remove power cord from the appliance.

Electrical appliances should be returned to designated collection points.